

Using GoTo Webinar

Open and close your control panel

Join audio:

- Choose **Computer Audio** to use VoIP
- Choose **Phone Call** and dial using the information provided

Submit questions and comments via the Questions panel

Note: Today's presentation is being recorded and will be provided within 48 hours.

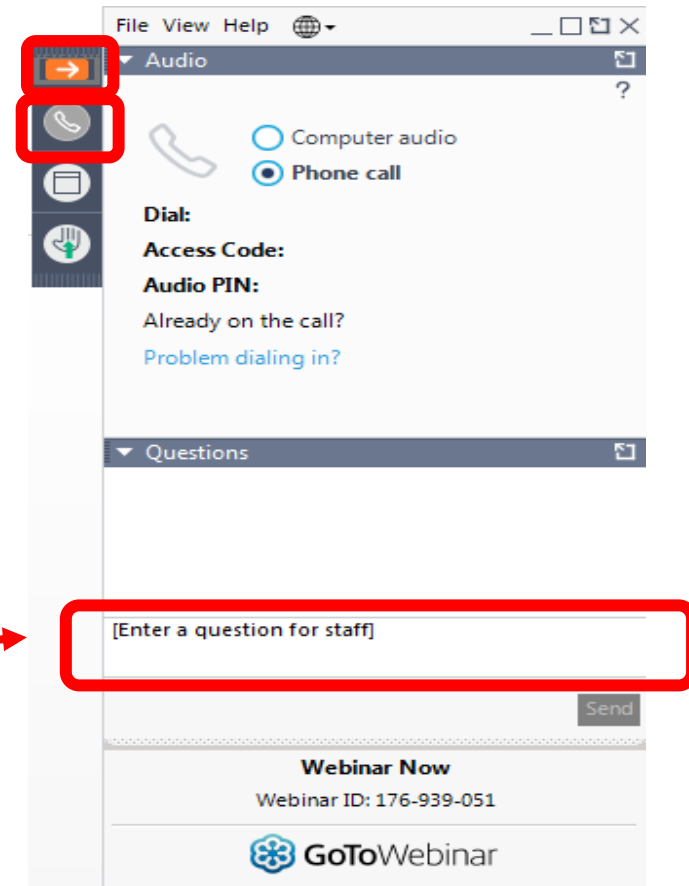

We will get started momentarily ...



Emergency Coastal Resilience Fund

2021 Applicant Webinar

December 7, 2021

Grand Isle, Louisiana, following Hurricane Ida

YOUR NFWF CONTACTS



Suzanne Sessine

Program Director, Coastal Programs
National Fish and Wildlife Foundation
(202) 595-2477
Suzanne.Sessine@nfwf.org

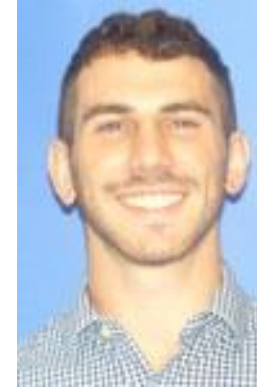

Zack Bernstein

Coordinator, Regional Programs
National Fish and Wildlife Foundation
(202) 595-2433
Zachary.Bernstein@nfwf.org

AGENDA

- **2021 Emergency Coastal Resilience Fund (ECRF) RFP Overview**
 - Program Overview
 - Geographic Focus
 - Program Priorities
 - Project Metrics
 - Eligibility
 - Funding Availability and Match
 - Evaluation Criteria
 - Timeline
- **How to Apply in Easygrants**
- **Questions?**



Emergency Coastal Resilience Fund - Overview



Wildfire in California

- Approx. \$24 M expected to be available in partnership with the National Oceanic and Atmospheric Administration (NOAA)
- Increase the resilience of coastal communities impacted by hurricanes and wildfires in 2020 and 2021



Emergency Coastal Resilience Fund - Overview

Funding available for coastal resilience projects that create and restore natural systems to:

Protect communities from the impacts of coastal storms, floods, sea-level rise, inundation, coastal erosion, and wildfires and associated landslides/debris flows

AND

Protect and restore habitat for fish and wildlife





EMERGENCY COASTAL RESILIENCE FUND

2021 REQUEST FOR PROPOSALS

Applicant Webinar [[Register](#)]: **Tuesday, December 7, 2021 at 3:00 – 4:00 PM ET**

Full Proposal Due Date: **Thursday, February 3, 2022 by 11:59 PM ET**

OVERVIEW

The National Fish and Wildlife Foundation (NFWF), in coordination with the National Oceanic and Atmospheric Administration (NOAA), is announcing the 2021 Emergency Coastal Resilience Fund (ECRF) to support projects that increase the resilience of coastal communities impacted by hurricanes and wildfires in 2020 and 2021. Funding for this program was appropriated under the Extending Government Funding and Delivering Emergency Assistance Act, 2022 (PL 117-43).

NFWF will award approximately \$24 million in grants to create and restore natural systems to help protect coastal communities from the impacts of coastal storms, floods, sea-level rise, inundation, coastal erosion, wildfires and associated landslides/debris flows, and enable communities to recover more quickly from these events, all while improving habitats for fish and wildlife species.

GEOGRAPHIC FOCUS

Coastal areas impacted by 2020 and 2021 hurricanes and wildfires:

The Emergency Coastal Resilience Fund priority geographies are highlighted in the maps below (See Figures 1-5). Eligible projects must be located within the outlined [National Coastal Resilience Fund](#) (NCRF) Coastal Areas *and* be within counties that received a federal Major Disaster Declaration with a Public Assistance designation as a result of hurricanes or wildfires in 2020 and 2021¹. These eligible geographies are shaded green on the maps below. The Coastal Area boundary is the same boundary used for NFWF's NCRF and is defined as coastal Hydrologic Unit Code (HUC) 8 watersheds that drain to the sea, plus any adjacent HUC 8 watersheds that are particularly low-lying or tidally influenced.² Projects in counties that received disaster declarations for multiple events may be prioritized.

¹ More information about disaster declarations available at: [Declared Disasters | FEMA.gov](#).

² To determine if a project falls within the NCRF coastal area boundary footprint, a more detailed map can be found here: <https://www.arcgis.com/apps/View/index.html?appid=1dd16c528fd844b49d765b51402feb8c&%3Bextent>

2021 Request for Proposals

- Process and timeline
- Geographic focus
- Program priorities
- Project metrics
- Eligibility
- Funding and Match
- Evaluation criteria
- How to apply
- Where to go for help

www.nfwf.org/programs/emergency-coastal-resilience-fund

Geographic Focus

In 2021, eligible projects must be:

- Within counties that received a federal Major Disaster Declaration with a Public Assistance designation as a result of hurricanes or wildfires in 2020 and 2021

AND

- Within the National Coastal Resilience Fund (NCRF) Coastal Area -- coastal Hydrologic Unit Code (HUC) 8 watersheds that drain to the sea, plus any adjacent HUC 8 watersheds that are particularly low-lying or tidally influenced

For more information about NCRF:

www.nfwf.org/coastalresilience



Gulf Coast

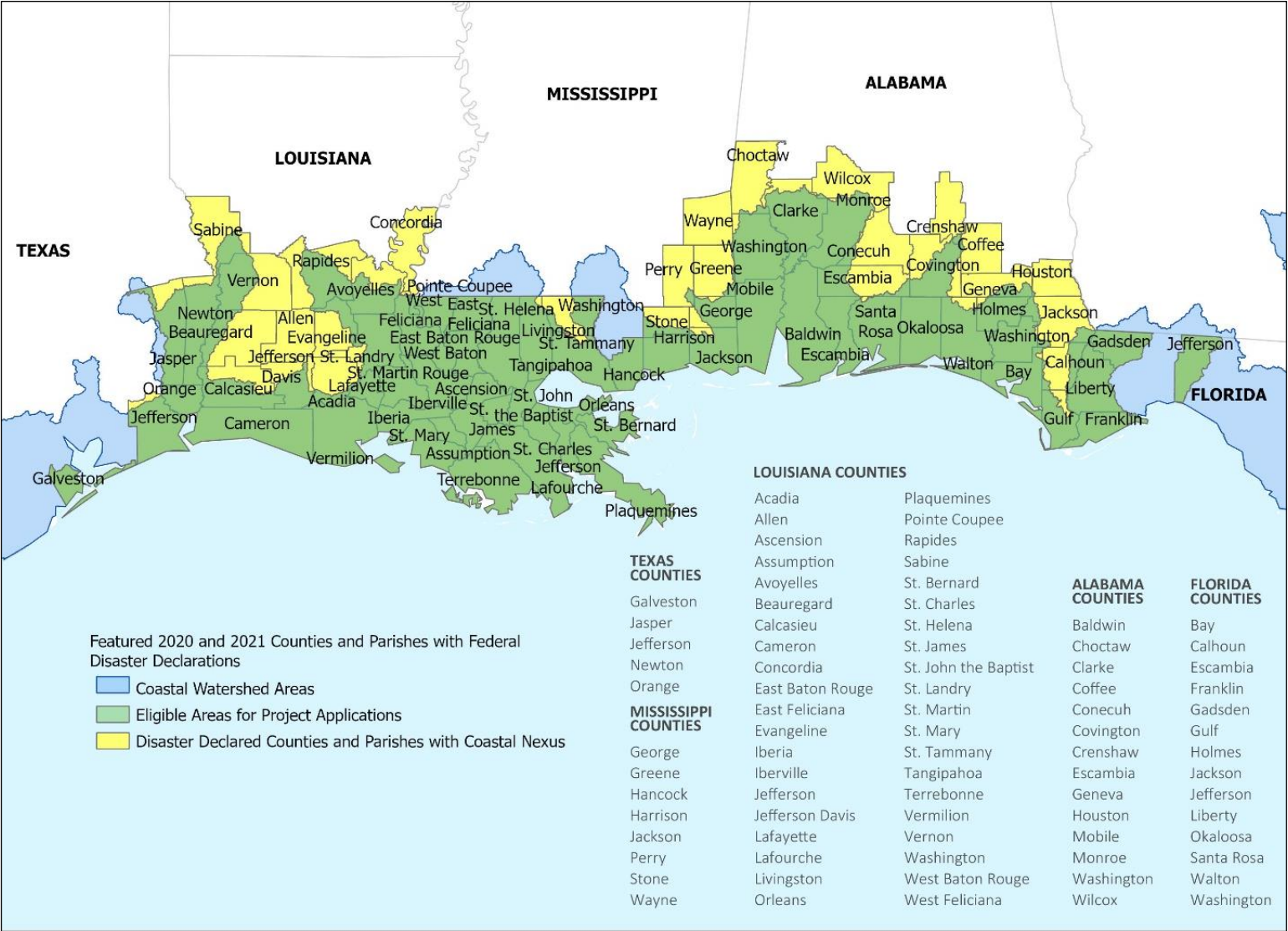

North Carolina

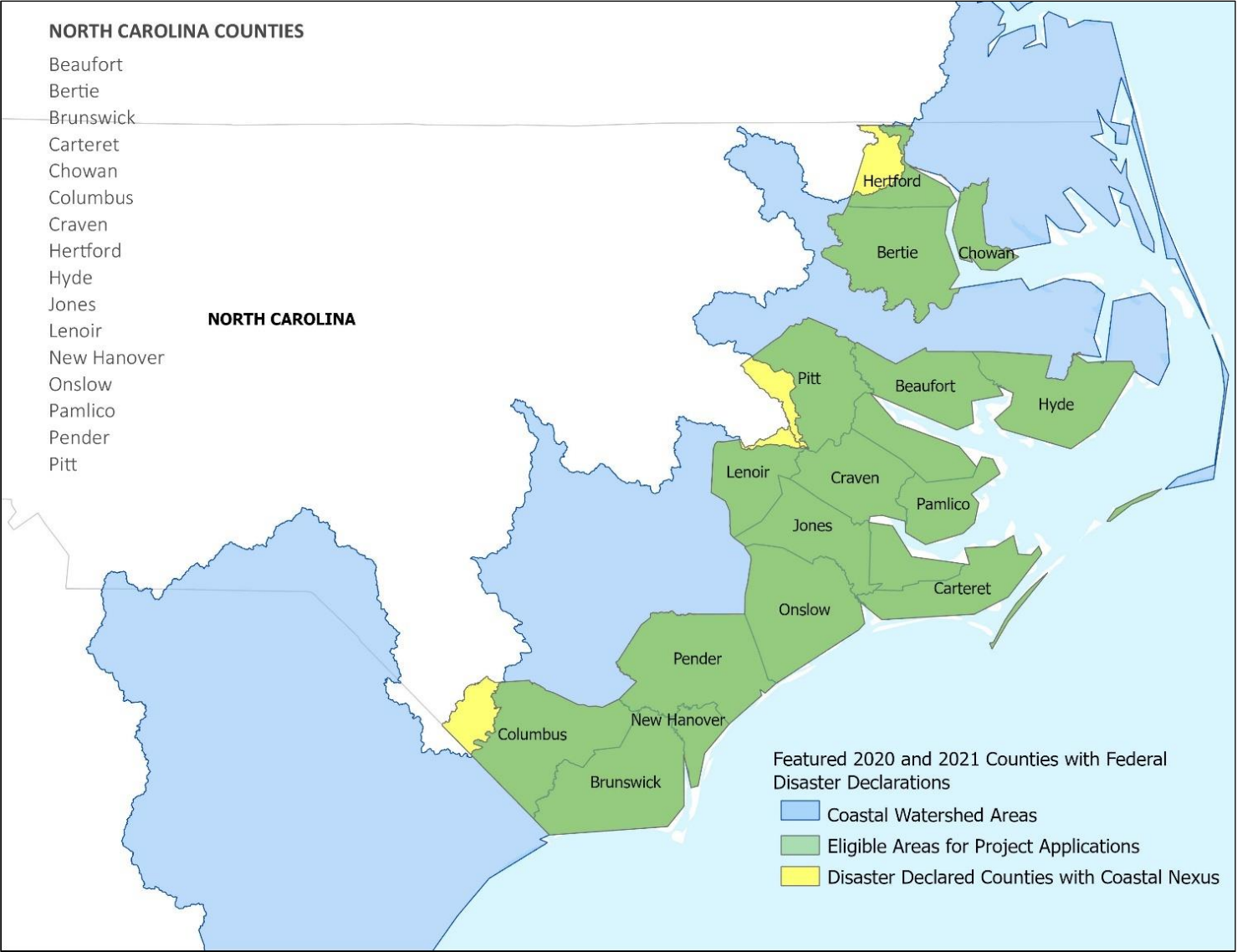

Northeast and Mid-Atlantic

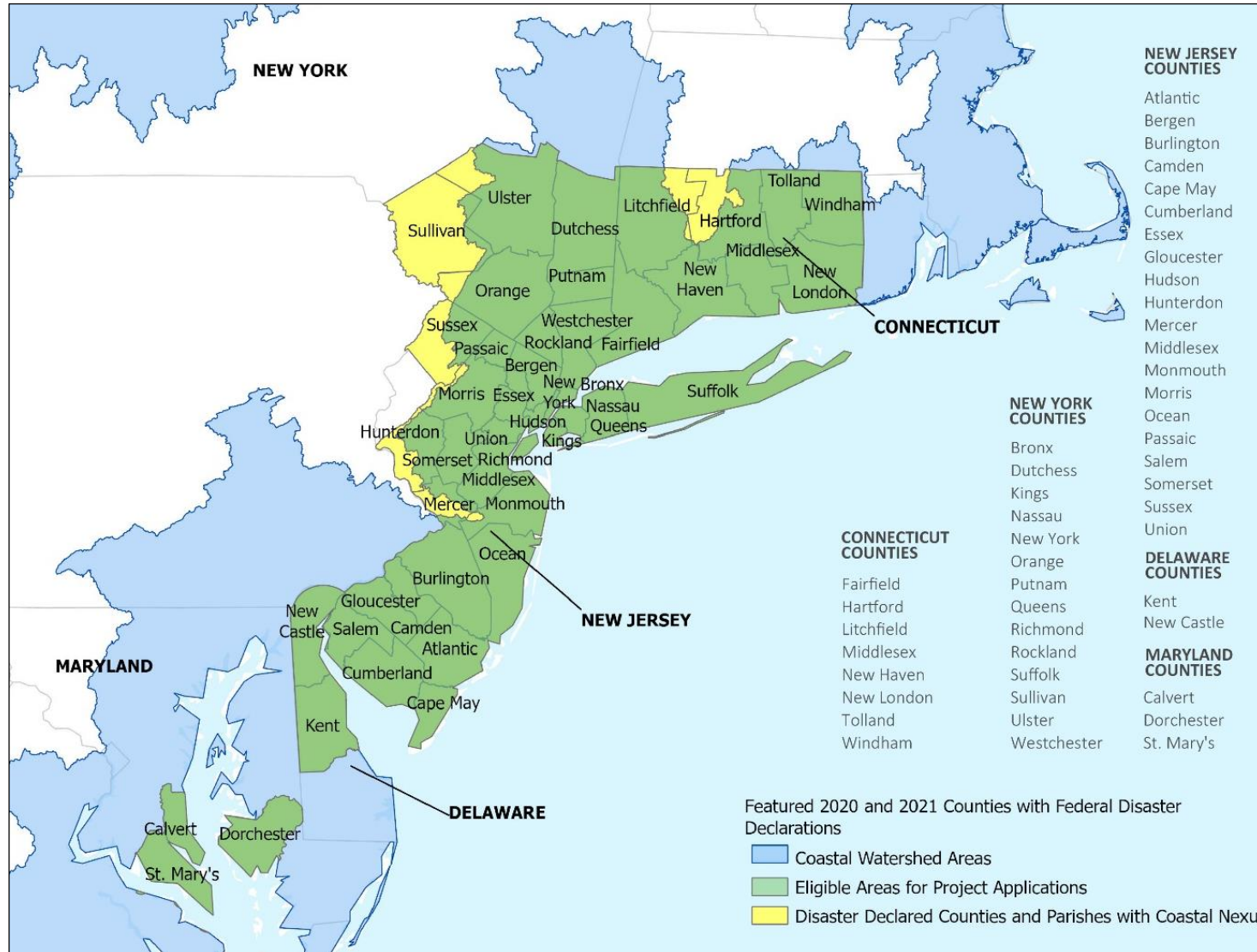

California

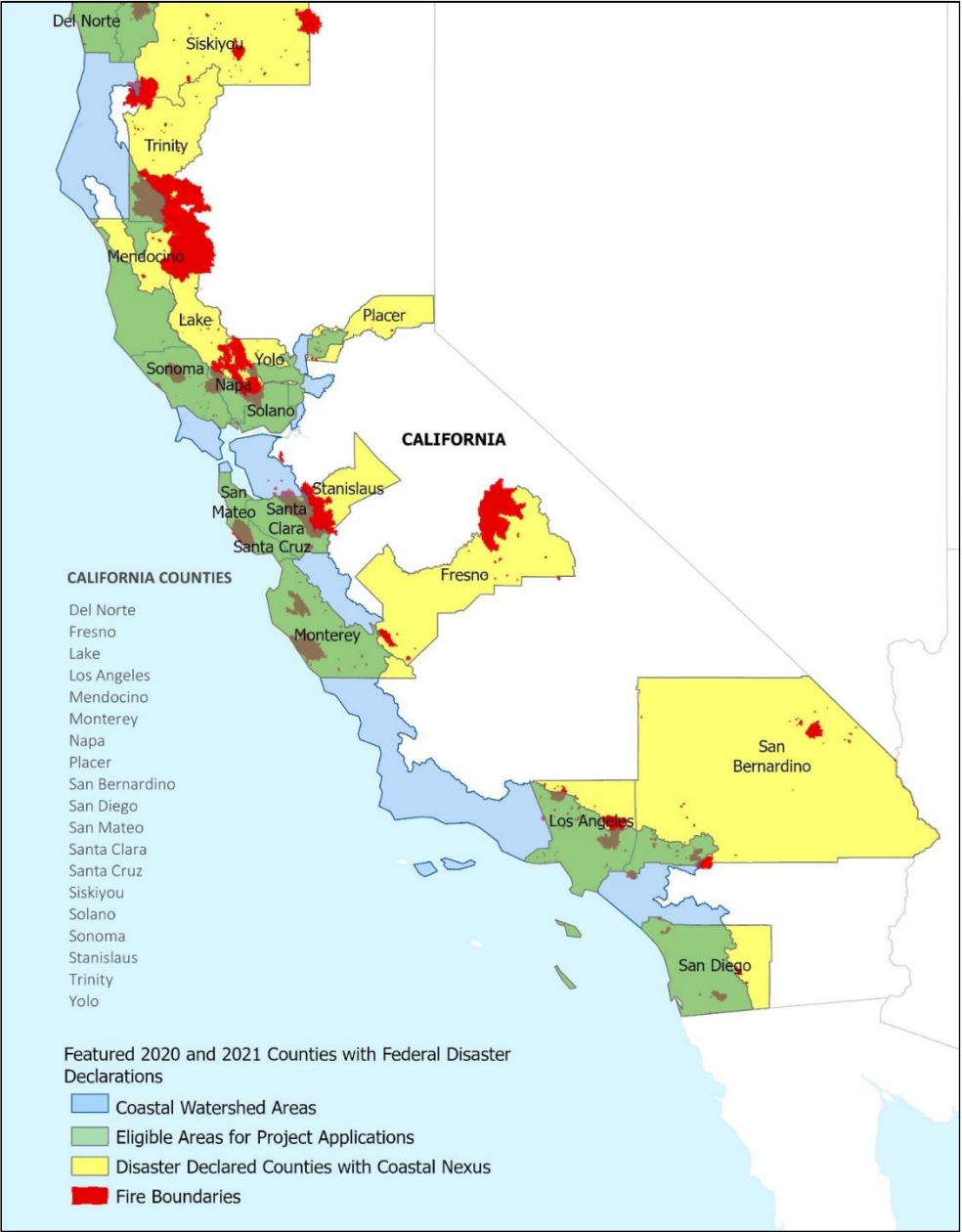

Pacific Northwest

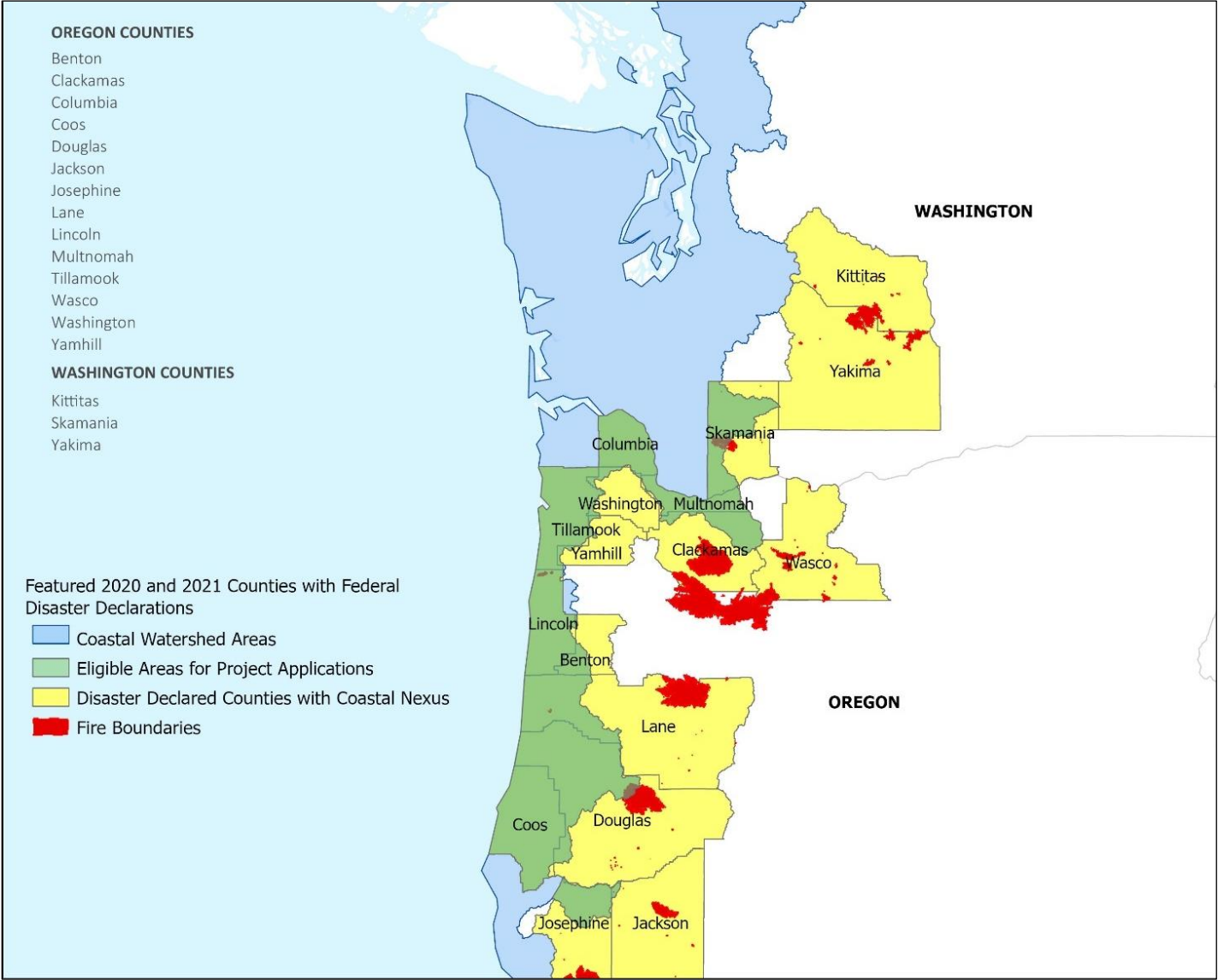

Geographic Focus

Questions about whether your project is within an eligible area?

Please contact:

Suzanne Sessine (*Suzanne.Sessine@nfwf.org*), or

Zack Bernstein (*Zachary.Bernstein@nfwf.org*)



Program Priorities

1. Restoration and Monitoring

Primary focus on projects ready for on-the-ground implementation that will provide the most accelerated and comprehensive outcomes to protect communities.

Project type examples:

- Marsh, wetland, beach and dune restoration
- Living shorelines
- Stream restoration, including aquatic connectivity
- Hazardous fuel reduction to prevent wildfires and revegetation to prevent debris flow



Program Priorities

1. Restoration and Monitoring (continued)

Projects are expected to range between \$1,000,000 to \$5,000,000, will vary based on project scope and scale

Project period: Up to 3 years

- Should include one year of post construction monitoring

Eligible lands include state, tribal, or local government lands, and private lands

- Private lands must show commitment to conservation
- Federal lands are not eligible

Final Engineering & Design

- Project should be shovel-ready within 12-18 months of award



Program Priorities

2. Site Assessment and Preliminary Design

Eligible activities:

- Evaluations of potential project sites
- Assessing alternatives for restoration and protection activities
- Gathering critically-needed baseline data
- Selecting most appropriate natural or nature-based solution
- Preparing preliminary project designs (generally 30-60%)

Average award expected to be \$250,000, but will vary based on project scope and scale

Project period: expected completion 12 months from start date

Proposals should provide examples of the natural features anticipated to be designed

Community should be able to make “go/no-go” decision, be ready to move to final design and permitting



Panama City Beach – Joe Raedle, Getty Images



ECRF – What is Not a Priority?

- Stand alone research or monitoring only projects
- Acquisition of land or conservation easements
- Small scale / isolated projects
- Non-natural structures (hardened shorelines, aquaculture)
- Community capacity building and planning (NCRF priority)



ECRF – Important Info Across Priorities

- Be specific about habitat and community resilience benefits
- Clearly identify how community or project has been prioritized for risk reduction and increased resilience
- We want to understand your efforts around community engagement
- Provide a clear timeline for proposed project activities and major milestones



Project Metrics

Restoration and Monitoring

Project Activity	Recommended Metric
Floodplain Restoration	Habitat Restoration – Floodplain Restoration – Acres Restored
Beach and/or Dune Restoration	Habitat Restoration – Beach Habitat Quality Improvements – Miles Restored
Marsh/Wetland Restoration	Habitat Restoration – Wetland Restoration – Acres Restored
Oyster Reef Restoration	Habitat Restoration – Marine Habitat Restoration – Acres Restored
Reforestation and Restoration of Forest Vegetation	Habitat Restoration - Land Restoration - Acres Restored
In-stream Restoration	Habitat Restoration – Instream Restoration – Miles Restored
Aquatic Connectivity Restoration	Habitat Restoration – Fish Passage Improvements - # of Fish Passage Barriers Rectified Habitat Restoration – Fish Passage Improvements – Miles of Stream Opened

Site Assessment and Preliminary Design

Project Activity	Recommended Metric
Site Assessment and Design Plans Development	Capacity, Outreach, Incentives - Volunteer Participation - # Volunteers Participating
Government Agency Participation and Engagement	Capacity, Outreach, Incentives – Outreach/Education/Technical Assistance - # of Governmental Entities Participating

Community Benefit and Outreach

Project Activity	Recommended Metric
Community Benefits	Planning, Research, Monitoring – Community Benefits Projected - # of Critical Facilities or Infrastructure Within Radius of Enhanced Protection
Community Outreach and Engagement	Capacity, Outreach, Incentives – Outreach/Education/Technical Assistance - # of People Reached by Outreach, Training, or Technical Assistance Activities Capacity, Outreach, Incentives – Volunteer participation - # of Volunteer Hours



NFWF

Restoration and Monitoring Projects

Required Monitoring Upload for Restoration and Monitoring proposals

Marsh and Living Shoreline Restoration

Beach and Dune Restoration

Floodplain Restoration

Link to monitoring guidance and template
available in ECRF RFP

Monitoring approaches for Marsh Restoration and/or Living Shorelines

[You must use Appendix A to complete this table]

Marsh Restoration and/or Living Shorelines					
Metric (include units)	Difference to Recommended Methods and Protocols (if any)	Spatial extent of metric monitoring	Baseline yr	Frequency/ Timing	Data Limitations/ Considerations
Percent Cover of biomass by species or cover type (% ranging from 0-100)					
Elevation (cm)					
Shoreline Position					
Water level					
Oyster reef restored (acres)(if applicable)					

Eligible Entities

Eligible

- State, tribal, territorial government agencies
- Municipal government
- Non-profit 501(c) organizations
- Educational institutions
- Commercial organizations

Ineligible

- Federal agencies or employees of federal agencies
- Foreign organizations
- Foreign public entities
- Unincorporated individuals



Ineligible Uses of Grant funds

- NFWF funds and matching contributions may not be used to support **political advocacy, fundraising, lobbying, litigation, terrorist activities** or Foreign Corrupt Practices Act violations.
- NFWF funds may not be used to support ongoing efforts to comply with **legal** requirements, including **permit conditions, mitigation** and **settlement agreements**. However, grant funds may be used to support projects that enhance or improve upon existing baseline compliance efforts.



Funding Availability and Match

- **Funding Availability:** Approx. \$24 million
- **Matching Contributions:**
 - Due to the emergency nature of these funds, a non-federal match is not required. If the request includes match, it can be any combination of cash and/or in-kind goods and services.
 - Federal leverage: Applicants are encouraged to describe federal partner contributions as well.
 - Questions? Please contact Suzanne Sessine (Suzanne.Sessine@nfwf.org), including inquiries regarding inclusion of matching contributions raised and spent prior to the Period of Performance.



Evaluation Criteria

All proposals will be screened for relevance, accuracy, completeness and compliance with NFWF and funding source policies. Proposals will then be evaluated based on the extent to which they meet the following criteria:

- Prioritized in Existing Plans
- Technical merit
- Partnership and Community Impact
- Cost-effectiveness
- Transferability
- Communication
- Monitoring and Adaptive Management
- Long-term Sustainability
- Past Success
- Innovation
- Scale or Comprehensiveness



Timeline

Dates of activities are subject to change. Please check the program page of the NFWF website for the most current dates and information.

Full Proposal Due Date

Thursday, February 3, 2022 by 11:59 p.m. ET

Review Period

February - April 2022

Awards Announced

May 2022

Request for Proposals:

<http://www.nfwf.org/programs/emergency-coastal-resilience-fund>



How to Apply in Easygrants



Black bear

How to Apply in Easygrants

[Frequently Asked Questions](#)

Log In

[New User?](#)

☒ Remember Me

[Forgot Password?](#)

Log In

For the optimal Easygrants experience, please:

[Use a Supported Browser](#)

[Enable Pop-ups](#)

[Allow Cookies](#)

[Only Use One Tab](#)

[Get Adobe Reader](#)

[Log Out and Close Browser for Security](#)

Register

First Name *

Middle Name

Last Name *

Login ID / Email *

Confirm Login ID / Email *

Password *

[Password Requirements](#)

Confirm Password *

Register

Back



How to Apply in Easygrants

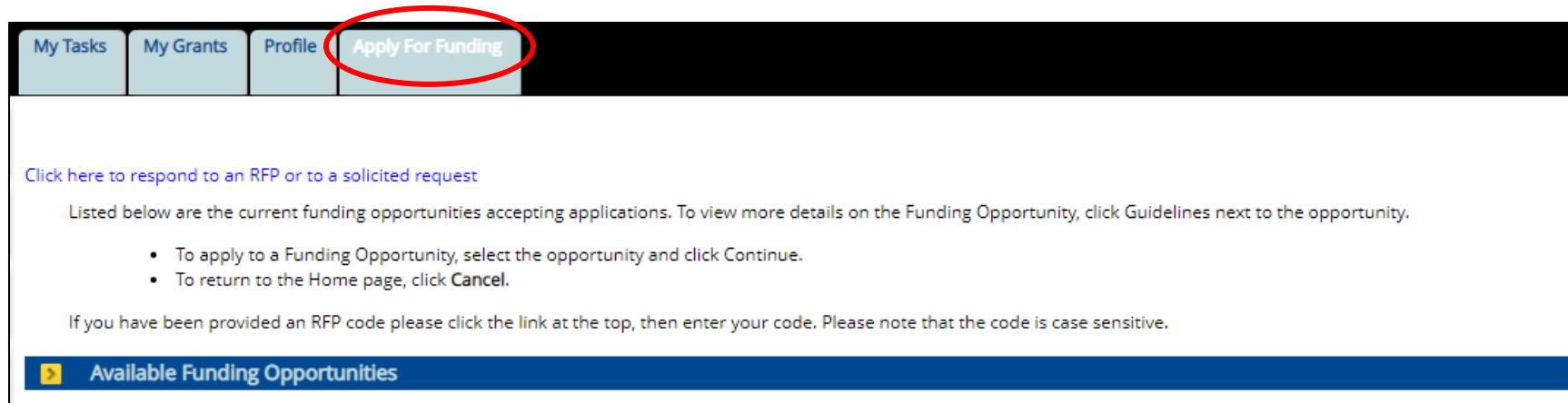

Once you are on your Easygrants homepage, click on “Apply for Funding”

Choose the Funding Opportunity you’re applying to.



Home

Main

Contact Information

Organization Information

Project Information

Project Location

Map

Uploads

Metrics

Budget

Matching Contributions

Permits and Approvals

Review and Submit

FAQ

Help

Log Out

> Project Information

Due: 7/14/2016 11:59 PM ET

Test, Heather |

Grants | Killer Whale Research and Conservation Program | Killer Whale Research and Conservation 2016

Easygrants ID: 54375

> Instructions

Click the page links on the left navigation bar, or in the summary below to view the pages where you will enter the information required for this submission. save and return to edit your information as many times as needed until you submit. Once you submit, you will no longer be able to make changes. [Click here](#) Other useful links that will appear in the navigation bar at left include:

- [Home](#) brings you back to your Home page and out of this submission task.
- [FAQ](#) provides answers to common questions about the Foundation's proposal elements.
- [Help](#) provides guidance on both content and technical aspects related to completing many of the pages in the system.
- [Log Out](#) logs you out of the system.

> Validation Summary

Page Name	Status
Contact Information	✓ Complete
Organization Information	✗ Incomplete
Project Information	✗ Incomplete
Project Location	✗ Incomplete
Map	✗ Incomplete
Uploads	✗ Incomplete
Metrics	✗ Incomplete
Budget	✗ Incomplete
Matching Contributions	✓ Complete
Permits and Approvals	✓ Complete

Project Information

Title: Short, descriptive name indicating project purpose. (~100 characters)

Project start and end dates: Start no earlier than March 1st 2022, end no later than December 31, 2025.

Description: Two sentences about primary project activities, location, outcome/metrics and relevance to conservation. (~500 characters)

- Clearly state the main activity and the method being used
- Address a specific habitat, location or species benefitted

Abstract: More detailed description including location, major activities, outcome/metrics, and partners. (~1,500 characters)

- State what your organization will do
- Provide context and background information
- Explain how the project outcomes will specifically address a conservation issue



Map

Map your project at the finest scale by any of the three options:

Upload Shapefile

- Select a Zip file(.zip) containing a shapefile(.shp,.dbf,.prj) from your local file system.
- The shapefile must be of POLYGON geometry type.
- The shapefile must not exceed 1 MB.

Choose File No file chosen

Select By Geography

Draw a Custom Area

My project area:

Submit Project Location

Submitted Project Locations

Pending Project Locations

I confirm that this project has been mapped as accurately as possible

Save and Continue



Uploads

Upload Checklist		
Upload Type	Required	Template
ECRF Full Proposal Narrative	Yes	
Project Map	Yes	
Letters of Support	Yes	
Photos - Jpeg	Yes	
Statement of Litigation	Yes	Statement of Litigation
Board of Trustees, Directors, or equivalent	Yes	
Applicant Controls Questionnaire	Yes	Applicant Controls Questionnaire Template
Applicant Demographic Information Form	Yes	Applicant Demographic Information Form
GAAP audited financial statements	Yes	
IRS Form 990	Yes	
A-133 Audit	Yes	
Indirect Rate Agreement	No	
Other Documents	No	

The full list of required uploads for your organization type is available on the NFWF website here:

<https://www.nfwf.org/apply-grant/application-information/required-financial-documents>



Project Narrative

1. Coastal Community Context
2. Activities
 - a) Use formatting to specifically call out primary activities
3. Outcome(s)
4. Project Team
5. Tracking Metrics
 - a) NFWF Program and Project Specific
6. Other (Optional)
7. Photos
8. Representative project photos



Full Proposal Project Narrative

Instructions: Save this document on your computer and complete the narrative in the format provided. The final narrative should not exceed ten (10) pages. You may delete instructions but not the headings in bold. Once complete, upload this document into the online application as instructed.

1. **Coastal Community Context:** Set the context for the need of this project in terms of risk to the coastal community and the efforts to date at this location that have prepared the community to engage in this project. Specifically describe actions and/or events leading up to this point that prioritize the proposed actions as well as any predicative modeling or threats assessments that have been done at this location.
2. **Activities:** List the main activities that will be employed with distinct headings and elaborate on the methodology and the expected progress within the grant period. Please link all activities to expected outcome(s) of the project and describe how they relate to established coastal resilience plans (management, conservation, recovery, etc.) and priority conservation needs in the specific project location. Please refer to the RFP for specific aspects of a priority application and provide appropriate detail on all methods.
3. **Outcome(s):** Elaborate on the outcome(s) anticipated for both the target coastal community and the targeted wildlife/habitat as a result of the project if funded. Outcomes should be specific and measurable and should reference how they align with established resilience plans where applicable (provide links to plans when possible). Outcomes that will not be achieved within the grant period but are anticipated as a direct result of the funding should also be described. Provide a bulleted list of annual milestones toward progress to outcomes and/or implementation table is required.
4. **Tracking Metrics:** Indicate how the project will monitor/assess progress on the metrics selected previously in the application. Please note any challenges or limitations anticipated with tracking the metrics. You may also list metrics that you will use to monitor success that are not part of NFWF's standard metrics.
5. **Matching Funds and Additional Leverage:** If less than 1:1 in non-federal matching funds are being proposed for this project, please provide a justification for why additional non-federal resources will not be able to be secured during the project period of performance. Please also describe any additional funding from federal sources being contributed to the project.
6. **Project Team:** List key individuals and describe their qualifications relevant for project implementation.
7. **Other (Optional):** Provide any further information important for the review of this proposal (i.e. other benefits to the project such as public access, recreational value).
8. **Representative Project Photos:** Via the Uploads section of the proposal, please include 1-3 photos of the project location or activities. For each uploaded photo, provide a photo credit and brief description below. *Example — Photo 1: John Smith, NFWF. Photo of the current eroded area to be addressed by plantings.*
Photo 1:
Photo 2:
Photo 3:

Designs, Site Maps and Letters of Support: Please see the RFP for other uploaded documents that are required for proposals. Letters of Support should be on letterhead where applicable.



Full Proposal Narrative

Describe the community(ies) where the project will take place, who will benefit from the project, and how they were or will be engaged in project development and implementation. Provide demographic information on the community(ies), including but not limited to age, race and ethnicity, poverty rates.

- Describe community characteristics of the project area and identify any communities impacted.
- Describe outreach and community engagement activities.
- Use demographic data to document (poverty statistics, school lunch data, demographic records to articulate high need or underserved communities).
 - This data can be found using Census data, School District data, State data centers, EJ Screen, and other sources



NFWF

Uploads - Applicant Demographic Information Form

- The information you provide will not be shared with proposal reviewers and will not be considered when making grant decisions.
- The Foundation will not share identifying information about any particular entity or project.
- While the form is a required upload, applicants can opt out of providing the information within the form itself
 - If your organization does not collect this information or if you have provided NFWF with this information in the last 12 months, you can opt out.
- The information provided on this excel form will be kept confidential, the Foundation may share its anonymized aggregate findings as appropriate with its staff, Board of Directors, funding partners, and publicly on its website or through other media.

APPLICANT DEMOGRAPHIC INFORMATION

As part of NFWF's goal to encourage and support diversity across the conservation projects we fund, we would like to better understand the existing diversity in our grantmaking community and in the local communities. To accomplish this task, we are asking organizations that we fund to assist us by providing basic information about their workforce demographics on this form.

As part of this effort to support diversity, we also desire to understand how our grantees engage with the communities where the projects take place and who in those communities might benefit from them. We ask for this information provided on this excel form will be kept confidential, although the Foundation may share its aggregate findings as appropriate with its staff, Board of Directors, funding partners, and publicly on its website. It does not share identifying information about any particular entity or project. These anonymized aggregate data will be used by NFWF to better understand the demographic profiles of the organizations that we fund.

The information you provide will not be shared with proposal reviewers and will not be considered when making grant decisions.

Instructions: Complete all pertinent fields shaded in green. Your Human Resources Department may have some of the information requested readily available. Please be sure to complete the General Information section. If you do not know an answer, use the "don't know/not sure" option instead of guessing. If a section does not apply to your organization you may skip it. Do not make any other changes to this form. You may opt out of providing this information to NFWF, however, you still must upload this form to [EquiSource](#) with your application and complete the first section of the form.

All applicants must complete this section, even if you have provided this data to NFWF in the past 12 months or are opting out for another reason.

If you have provided this data to NFWF in the past 12 months you do not need to provide it again but you must still complete this top section of the form and submit it with your proposal.

Essegrants project # from your grant application:

Grant program name shown on the RFP:

If you are opting out, select a reason from the dropdown list in the green box:

General Information

Date Completed:

Project Title:

Organization Full Name:

Organization EIN:

Organization Type:

Organization Size (number of employees):

Click on the green box to select from the dropdown list

Click on the green box to select from the dropdown list

PART 1: APPLICANT ORGANIZATION - ALL EMPLOYEES (if applicable)

Please provide the following demographic information about all of your organization's employees, including senior leaders.

1. How many people currently work for your organization? (Include temporary and part-time employees in your response but do not include contractors.)

Total Number:

2. How many of your employees identify as each gender?

Female:

Male:

Non-binary:

Unknown/Not sure:



NFWF

Metrics

NFWF

Home

Main

Contact Information

Organization Information

Project Information

Project Location

Map

Uploads

Metrics

Budget

Matching Contributions

Permits and Approvals

Review and Submit

Select Metric

Show: Show All Templates Show All Strategies

Search:

Add	Metric	Strategies	Required
<input type="checkbox"/>	Resilience - Land restoration - Acres restored	Habitat Restoration	Recommended
<input type="checkbox"/>	Resilience - Instream restoration - Miles restored	Habitat Restoration	Recommended
<input type="checkbox"/>	Resilience - Restoration planning/design/permitting - # E&D plans developed	Planning, Research, Monitoring	Recommended
<input type="checkbox"/>	Resilience - Wetland restoration - Acres restored	Habitat Restoration	Recommended
<input type="checkbox"/>	Resilience - Outreach/ Education/ Technical Assistance - # govt entities participating	Capacity, Outreach, Incentives	Recommended
<input type="checkbox"/>	Resilience - Marine habitat restoration - Acres restored	Habitat Restoration	Recommended
<input type="checkbox"/>	Resilience - Volunteer participation - # of volunteer hours	Capacity, Outreach, Incentives	Recommended
<input type="checkbox"/>	Resilience - Fish passage improvements - # passage barriers rectified	Habitat Restoration	Recommended
<input type="checkbox"/>	Resilience - Beach habitat quality improvements - Miles restored	Habitat Restoration	Recommended
<input type="checkbox"/>	Resilience - Fish passage improvements - Miles of stream opened	Habitat Restoration	Recommended
<input type="checkbox"/>	Resilience - Outreach/ Education/ Technical Assistance - # people reached	Capacity, Outreach, Incentives	Recommended

☐ Select All

Add SelectedClose

Filter By: ECRF Metrics Show All Strategies

No results to display

☐ Select AllDelete Selected

SaveSave and Continue

Budget

- In order to complete a budget for your proposal, you must expand the appropriate categories and provide the information requested.
- If you do not anticipate an expense for a particular category, skip that category- it is not necessary to enter a "0" value in the cost fields.
- Try to anticipate factors that may affect the budget when developing projections and provide an explanation of those factors.
- Matching contributions (if included) should not be included in the budget.

Budget

Expand all

➤ <u>Personnel</u>	\$0.00
➤ <u>Travel</u>	\$0.00
➤ <u>Equipment</u>	\$0.00
➤ <u>Materials and Supplies</u>	\$0.00
➤ <u>Contractual Services</u>	\$0.00
➤ <u>Other Direct Costs</u>	\$0.00
<u>Total Direct Costs</u>	\$0.00
<u>Total Indirect Costs</u>	\$0.00
<u>Total Costs</u>	\$0.00

Budget

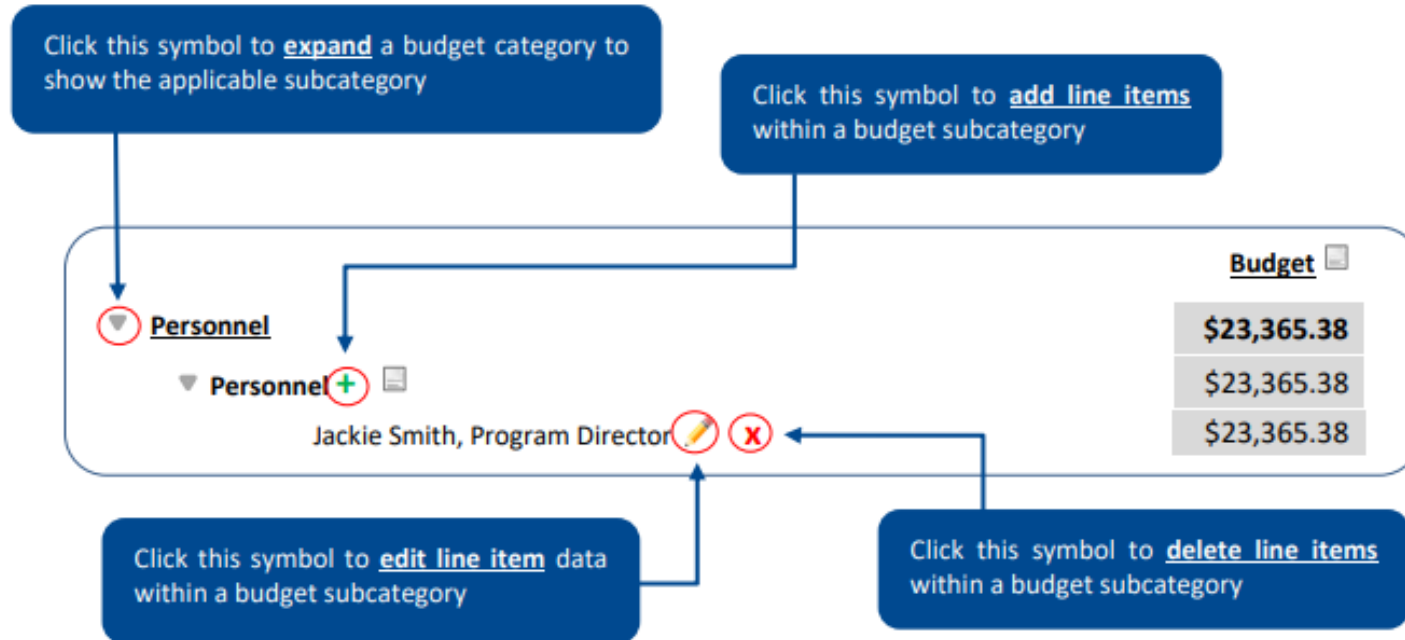

Detailed Budget Instructions: Adding/Editing Narratives

- Narratives are required for all budgeted categories.
 - Explain/justify the estimated costs including the unit cost and quantity requested
 - Explain how the costs associated with each line item supports the implementation of the project as outlined in the proposal
- Narratives should be written in such a way that someone not familiar with the project can conceptually understand the **rationale**, **purpose** and **calculation** of the anticipated costs identified by line item.
- Narratives should be concise and describe line items in 1-3 sentences.

Figures without narrative descriptions will be returned to the applicant for further details and clarification.

Click this symbol to add a narrative within a budget subcategory

	Budget
Personnel	\$23,365.38
Personnel + 	\$23,365.38

Next, complete the narrative box as shown below:

Notes	
Line Item Budget	Personnel
Budget	Jackie Smith will manage all aspects of the program which includes, surveys of the project site alongside field techs, landowner interviews and follow-ups, and supervision of volunteers during sponsored work days.
Save	Save and Close
Cancel	

Matching Contributions

← → ↻

https://easygrants.nfwf.org/NFWF/Implementation/Modules/Application/ModuleContent.aspx?Config=FullProposalNewMetrics50004

NATIONAL FISH AND WILDLIFE FOUNDATION

NFWF

Matching Contributions Editor - Heather Test - Full Proposal

Home

Main

Contact Information

Organization Information

Project Information

Project Location

Map

Uploads

Metrics

Instructions

Enter the required matching contribution details below. Click **Save** regularly to save your work. The system will timeout and you will lose unsaved work if you do not save. Click **Help** for examples and instructions.

Matching Contribution

Matching Contribution Amount *

Matching Contribution Type *

Matching Contribution Source *

Matching Contribution Source Type *

Matching Contribution Status *

Matching Contribution Description/Notes *

\$50,000.00

Cash

Happy Whale Foundation

Enter the name of the person or Organization providing the Matching Contribution.

Non-Federal

Application Submitted

Funds will cover the salary and benefits of the project coordinator.

Limit: 250 characters

Remaining: 182

Save

Save and Close

Close

The logo for the National Fish and Wildlife Foundation (NFWF). It features a circular emblem on the left with a stylized fish and a bird, surrounded by the text "NATIONAL FISH AND WILDLIFE FOUNDATION". To the right of the emblem is the acronym "NFWF" in a large, bold, sans-serif font.

Review and Submit

- Make sure to click the blue “Submit” button to submit your proposal.
- If correctly submitted, you will receive a confirmation e-mail and the task will disappear from your homepage.

NOTE: You must enable pop-ups to use this system. If a link does not open please try holding the Shift or Control (CTRL)

Project Location

Map

Uploads

Budget

Matching Contributions

Permits and Approvals

Review and Submit

FAQ

Help

Log Out

View Full Submission

View PDF

Submission

Validation Status

Page Name	Status
Contact Information	✓ Complete
Organization Information	✗ Incomplete
✗ Primary Organization is required	
Project Information	✗ Incomplete
✗ Project Title is required.	
✗ Project Start Date is required.	
✗ Project End Date is required.	
✗ Description is required	
✗ Abstract is required.	
✗ Requested Amount is required.	
Project Location	✗ Incomplete
✗ Project Location Description is required.	
✗ Project Location Country(s) is required.	
Map	✗ Incomplete
✗ Please confirm your project has been accurately mapped.	
Uploads	✗ Incomplete
✗ GAAP audited financial statements is required and has not been uploaded.	
IRS Form 990 is required and has not been uploaded.	
A-133 Audit is required and has not been uploaded.	
Board of Trustees, Directors, or equivalent is required and has not been uploaded.	
Statement of Litigation is required and has not been uploaded.	
CBWTP Full Proposal 2021 is required and has not been uploaded.	
CBWTP 5 Year Transaction Projection 2021 is required and has not been uploaded.	
CBWTP Work Elements 2021 is required and has not been uploaded.	
Budget	✓ Complete
Matching Contributions	✓ Complete
Permits and Approvals	✓ Complete

Deadlines and Contacts

Proposals Due	Thursday, February 3, 2022 by 11:59 pm EST
Review Period	February – April 2022
Awards Announced	May 2022

Questions about the RFP or Easygrants:

Suzanne Sessine
Program Director, Coastal Programs
Suzanne.Sessine@nfwf.org

Zack Bernstein
Coordinator, Regional Programs
Zachary.Bernstein@nfwf.org

Easygrants Helpdesk:
Email: easygrants@nfwf.org
Voicemail: 202-595-2497

Region-specific questions:

If you have a question about...

Gulf States and North Carolina

Northeastern States (NY, CT)

Mid-Atlantic States (MD, DE, NJ)

West Coast

Please contact...

Suzanne Sessine,
Suzanne.Sessine@nfwf.org

Lynn Dwyer,
Lynn.Dwyer@nfwf.org

Stephanie Heidbreder,
Stephanie.Heidbreder@nfwf.org

Jonathan Birdsong,
Jonathan.Birdsong@nfwf.org



NFWF

Questions?

